

W-STYLE PARTS

W-Style Dual Spring Balancer Assemblies For Dry Freight Doors

Includes shaft, LH and RH springs, winding cones, cable drums with bearings and spring spacers. Springs treated with rust preventer.

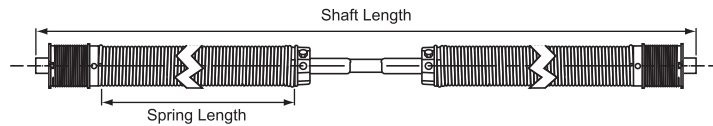

Product #	Shaft Length	Spring Length	Wire Diameter
H67W23761391352	52"	16.75"	.139"
H67W23761822987	87"	33"	.182"
H67W23761822993	93"	33"	.182"
H67W23761873187	87"	35"	.187"
H67W23761873193	93"	35"	.187"

W-Style Replacement Spring & Spring Assemblies

Supplied as either plain spring only or as assembly as noted per chart. Assemblies include cable drum bearing assembly and winding cone pre assembled to spring. Roadside cable drum is colour code red.

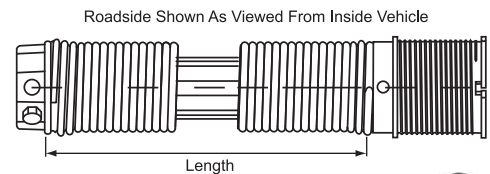

Product #	Spring Only	Application	Spring Length	Wire Diameter
H67W270413914	Yes	Roadside	14"	.139"
H67W270416217.5	Yes	Roadside	17.5"	.162"
H67W270418233	No	Roadside	33"	.182"
H67W270418735	No	Roadside	35"	.187"
H67W270513914	Yes	Curbside	14"	.139"
H67W270516217.5	Yes	Curbside	17.5"	.162"
H67W270518233	No	Curbside	33"	.182"
H67W270518735	No	Curbside	35"	.187"



W-Style Dual Spring Balancer Shaft

Shaft is 1" overall diameter steel tubing and formed in center to .81" square. One end drilled for cotter pin insertion. Plain steel finish.

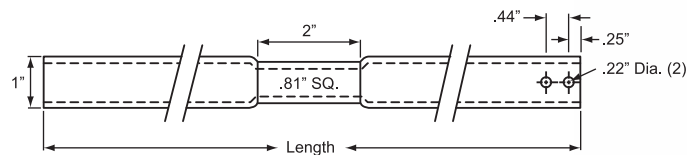

Product # H67W252887 87" OAL

Product # H67W252893 93" OAL

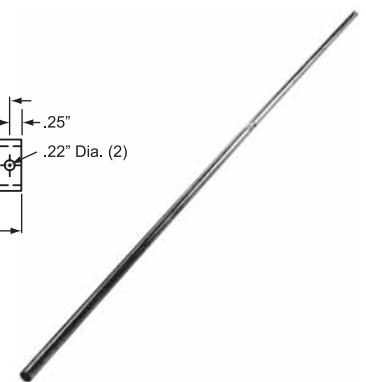

W-STYLE PARTS

W-Style Spring Spacer

Extruded PVC with zinc plated thrust washer.

Product # H67W247133 33" OAL

Product # H67W247135 35" OAL

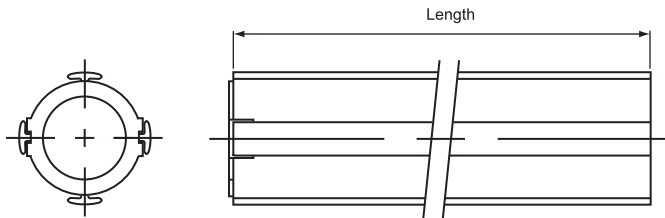

W-Style Dual Spring Balancer Winding Cone

Product # H67W2518

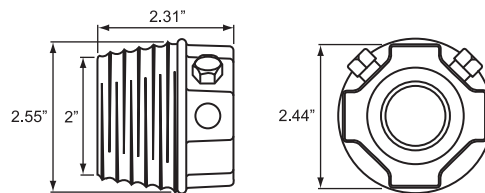

W-Style Cable Drum & Bearing Assembly

Black nylon drum has integral bearing and angled cable slot. Roadside drum is colour coded red.

Product # H67W2547 Roadside (LH)
Colour Code Red

Product # H67W2548 Curbside (RH)

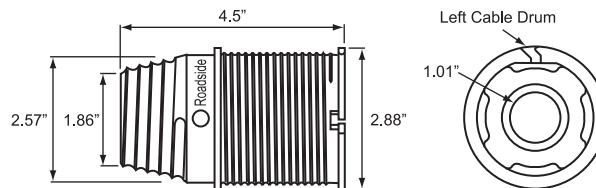

W-Style Balancer Mounting Brackets

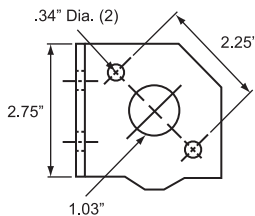

End Roadside

Product # H67W2524

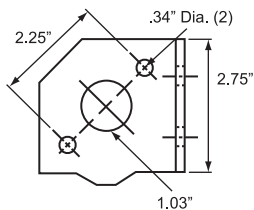

End Curbside

Product # H67W2523

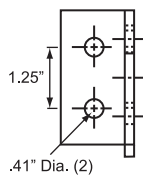

Center

Product # H67W2525

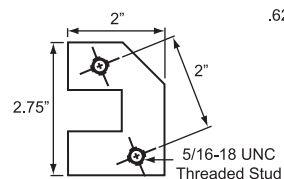

Clamp

Product # H67W2526

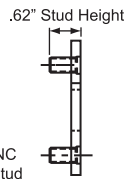

W-STYLE PARTS

W-Style Outside Door Cables With Aluminum Eye End With 5/16" Hole

Product #	Cable O.A.L.	Style
H67W17GA	97"	7x19 Strand Galvanized
H67W17SS	97"	7x19 Strand Stainless
H67W18GA	110"	7x19 Strand Galvanized
H67W18SS	110"	7x19 Strand Stainless
H67W110GA	125"	7x19 Strand Galvanized
H67W110SS	125"	7x19 Strand Stainless
H67W14GA	130"	7x19 Strand Galvanized
H67W14SS	130"	7x19 Strand Stainless

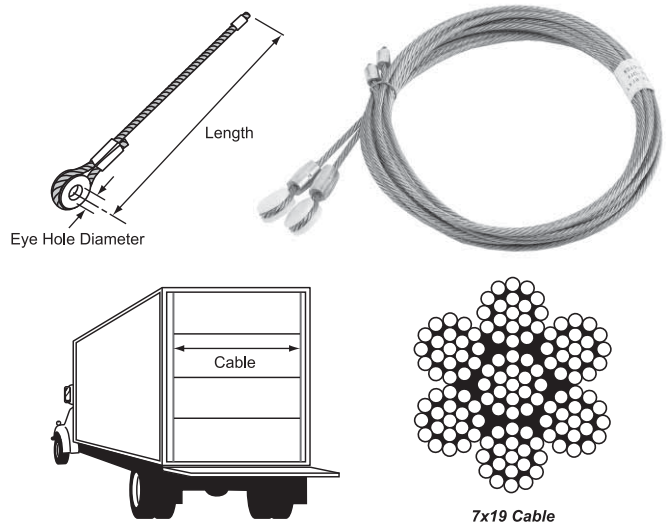

**** Cables Are Sold By Each. Non Standard Length Cables And Cables With 7/16" Cable Eye Are Available. Please Contact Our Sales Department With Your Requirements. ****

W-Style Bottom Panel Cable Anchor

Zinc plated steel U-bolt secures cable to door bottom panel. 5/16 UNC nuts sold separately.

Product # H67W7013ZN

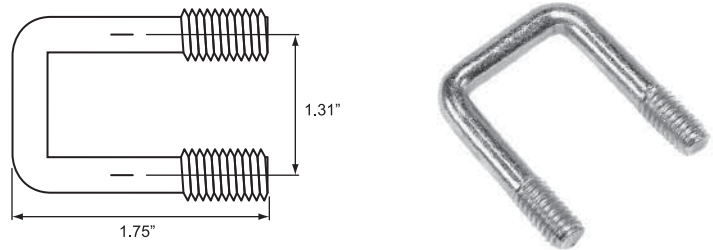

W-Style Top Closure Plate & Slide Assembly

Heavy duty reinforced slide, base plate and zinc plated hardware allows top panel adjustment for tight seal.

Product # H67W6944 Complete Assembly Zinc Plated

Product # H67W6944BK Complete Assembly Black E-Coat

Product # H67W6944SS Complete Assembly Stainless Steel

Component Parts:

Product # H67W1264 Base Plate Only; Zinc Plated

Product # H67W6943 Slide Only; Zinc Plated

Product # H67W1726 Old Style Non Reinforced Slide Only; Zinc Plated

Product # H67W2370 Plated 5/16" UNC Slider Bolt (Does Not Include Flanged Nut)

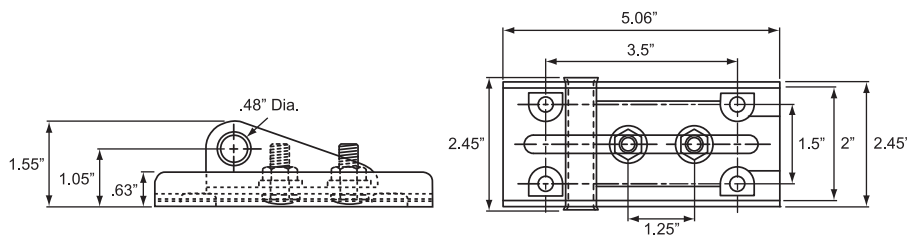

W-STYLE PARTS

W-Style Bottom Roller Holders

Single stud assembly. Zinc plated.

Product # H67W1371

Double hole cover only. Black E-Coat.

Product # H67W1208BK

Double stud inner base only. Black E-Coat.

Product # H67W2032BK

HD bottom roller holder assembly. Black E-Coat.

Product # H67W7181BK

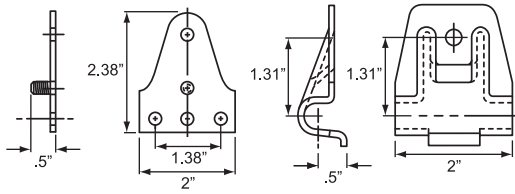

H67W1371 Illustrated

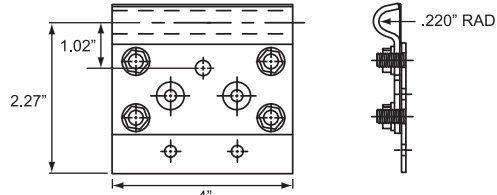

H67W7181BK Illustrated



W-Style End Hinges & Parts

Black E-Coat finished steel or stainless.

Product # H67W1209BK Complete Hinge Assembly

Product # H67W1208BK Roller Cover Only

Product # H67W1207BK Hinge Only

Product # H67W1209SS Stainless Complete Hinge Assembly

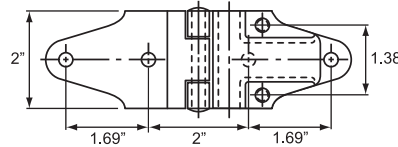

W-Style Center Hinge

Black E-Coat finished steel or stainless.

Product # H67W15BK Black E-Coat Hinge

Product # H67W15SS Stainless Hinge

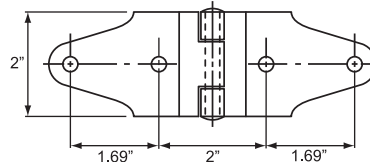

W-Style Dry Freight Door Cam Lock

Product # H67W77BK Black E-Coat Finish
"J" Cam Lock Handle
With Offset Back Plate

Product # H67W2766BK Black E-Coat Finish
Handle Keeper

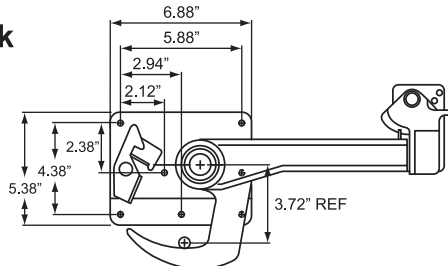

W-Style Weld In Lock Catch Plate

Plain steel.

Product # H67W2804

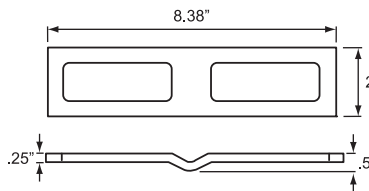

W-STYLE PARTS

W-Style ColdSaver or TempSaver Door Cam Lock

Black E-Coat finish.

Product # H67W7510BK

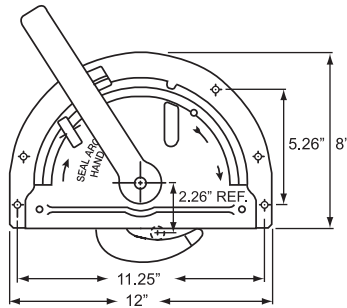

2" Style Vertical Track & Right Angle Assembly

Galvanized 14 gauge right angle integral mounting track, vertical track and operator bracket. Tongue and grooved for joint alignment, for 2" rollers.

Product # H67W2275196 Curbside Track, 96.5" OAL, For Doors 72-90" High

Product # H67W2275296 Roadside Track, 96.5" OAL, For Doors 72-90" High

Product # H67W22751106 Curbside Track, 106.5" OAL, For Doors 91-100" High

Product # H67W22752106 Roadside Track, 106.5" OAL, For Doors 91-100" High

Product # H67W22751120 Curbside Track, 120" OAL, For Doors 101-114" High

Product # H67W22752120 Roadside Track, 120" OAL, For Doors 101-114" High

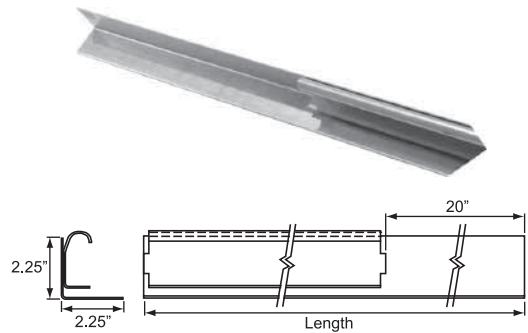

8" Radius 2" Horizontal Tracks

Galvanized 14 gauge radius track. Tongue and grooved for joint alignment. For use with 2" rollers.

Product # H67W112107 Curbside Track, 107" OAL
For Doors Up To 96" High

Product # H67W113107 Roadside Track, 107" OAL
For Doors Up To 96" High

Product # H67W112120 Curbside Track, 120" OAL
For Doors Over 96" High

Product # H67W113120 Roadside Track, 120" OAL
For Doors Over 96" High

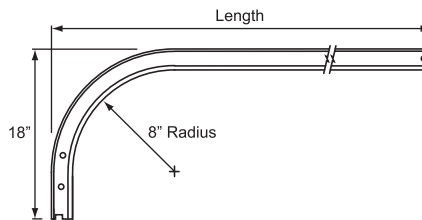

W-Style PVC Bottom Seal

98" long.

Product # H67W1676

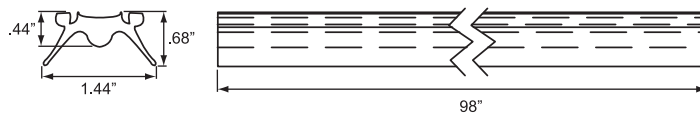

W-Style Bottom Seal Retainer

Aluminum extruded and 98" long.

Product # H67W1801

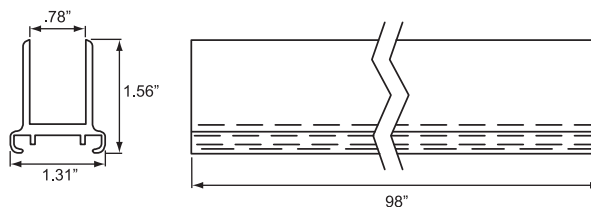

W-STYLE PARTS

W-Style Offset Bottom Seal

Rigid and flexible co-extruded dual durometer.

Product # H67W5735

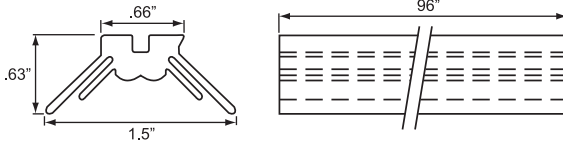

W-Style Offset Bottom Seal Retainer

Aluminum extruded.

Product # H67W8280

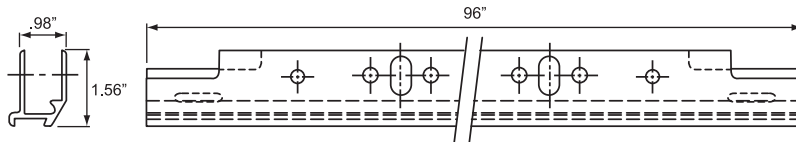

Head Seals & Retainer

Aluminum extruded retainer used with W-style rubber or brush style seals. Mounted to top door panel.

Product # H6769790X Extrusion Only; 96" OAL

Product # H6769718X Rubber Seal; 96" OAL

Product # H6769719X Brush Seal; 96" OAL

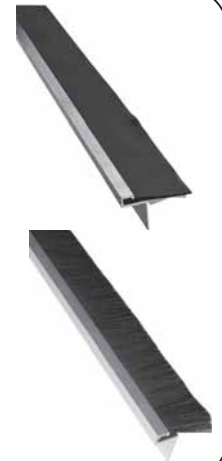
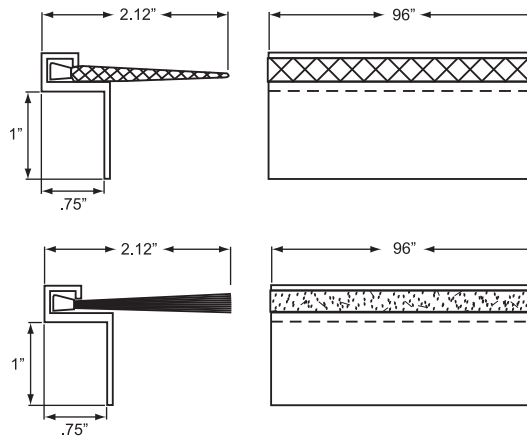

W-Style Side Seal

Dual durometer side seal uses rigid PVC backing with flexible PVC door seal. Use only with right angle verticle track.

Product # H67W5423 115" Long

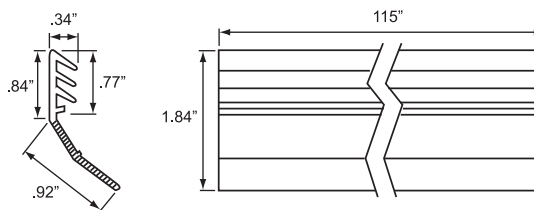

W-Style Reefer Side Seal

Co-extruded with rigid PVC backing and flexible PVC door seal

Product # H67W7470 98" Long

