

# FITTINGS

## Screw Pin Anchor Shackle

High tensile forged steel with a hot dip galvanized finish. Load limit and size marked on shackle. Meets federal specification RR - C - 271D, Type IV Class I alloy pin.

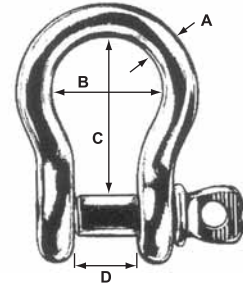

Product #	"A" Body Size	Pin Diameter	"B" Inside Bow	"C" Inside Length	"D" Opening	Safe Working Load Limit
H6329020016	1/4"	.3125"	.75"	1.125"	.5"	1000 lbs
H6329020020	5/16"	.375"	.875"	1.25"	.5"	1500 lbs
H6329020024	3/8"	.4375"	1"	1.4375"	.625"	2000 lbs
H6329020028	7/16"	.5"	1.125"	1.6875"	.75"	3000 lbs
H6329020032	1/2"	.625"	1.3125"	1.875"	.75"	4000 lbs
H6329020040	5/8"	.75"	1.625"	2.375"	1.0625"	6500 lbs
H6329020048	3/4"	.875"	2"	2.75"	1.25"	9500 lbs
H6329020056	7/8"	1"	2.25"	3.3125"	1.4375"	13000 lbs
H6329020060	1"	1.125"	2.6875"	3.75"	1.6875"	17000 lbs
H6329020066	1-1/8"	1.25"	2.625"	4.25"	1.75"	19000 lbs
H6329020072	1-1/4"	1.375"	3"	4.6875"	2"	24000 lbs
H6329020076	1-1/2"	1.5625"	3.875"	5.75"	2.375"	34000 lbs

## Shoulder Eye Bolts - Grade C1030

Forged carbon steel, self coloured proof tested in accordance with ASTM A489.

**\*\* WARNING: Working Load Limit Is Based On Straight Pull Loads. Angle Of 45° Reduces Working Load Limit To 25% Of Value. \*\***

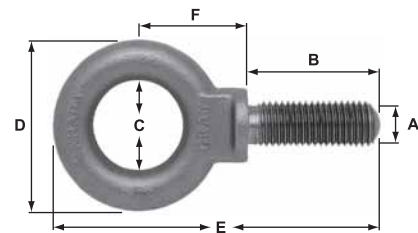

Product #	"A" Thread Size	"B" Shank Length	"C" I.D. Eye	"D" O.D. Eye	"E" Overall Length	"F" Center of Eye To Shoulder	Safe Working Load Limit
H6356708PL	1/4-20	1"	3/4"	1-3/16"	2-3/8"	3/4"	650 lbs
H6356723PL	3/8-16	1-1/4"	1"	1-11/16"	3-9/32"	1-1/8"	1550 lbs
H6356725PL	1/2-13	1-1/2"	1-3/16"	2-1/8"	3-31/32"	1-3/8"	2600 lbs
H6356727PL	5/8-11	1-3/4"	1-3/8"	2-9/16"	4-3/4"	1-21/32"	5200 lbs
H6356728PL	3/4-10	2"	1-1/2"	2-13/16"	5-1/4"	1-13/16"	7200 lbs
H6356732PL	1-8	2-1/2"	1-13/16"	3-9/16"	6-5/8"	2-5/16"	13300 lbs
H6356736PL	1-1/8-7	2-3/4"	2"	4-1/16"	7-17/32"	2-11/16"	17000 lbs